



# MAYFAIR

FIRE SOLUTIONS

BY MAYFAIR GROUP



# COST EFFECTIVE DOOR SOLUTIONS

## 3. Introduction

4 - 6. Manufacturing Facility and Certification

7 - 11. Recent and Other Projects

12. Manufacturing Process

13. Bespoke Doors

14 - 15. Door Leaf Constructions British Standards

16 - 17. Door Leaf Constructions ANSI Standards

18. Lipping Details

19. Door Leaf Finish Options

20 - 21. Veneers

22. Laminate and PVC faced options

23 - 24. Vision Panels

25 - 26. Frame Options

27 - 28. Perimeter Seals

29. Factory Installed Ironmongery for Doorsets

30. Market Sectors

31. Delivery Logistics

**MAYFAIR**  
FIRE SOLUTIONS



# MAYFAIR

## FIRE SOLUTIONS

Mayfair Fire Solutions is a subsidiary of the Mayfair Group, a UAE-registered entity. Our manufacturing arm, located and registered in India (registered name Timbmet Door Solutions Ltd. (TDSL), and trading as Mayfair Fire Door Manufacturing), is an internationally acclaimed doors manufacturing, and ironmongery business with experience in sales extending to the UK, Hong Kong, Australia and U.S.A.

Our fully certified doors manufacturing facility is based in North West India and produces a comprehensive range of fire and non-fire doors as well as doorsets. Our facility has supplied products to multiple high-profile projects in the UK, Middle East, India, and Australia over several years and has built an excellent reputation for high quality yet affordable solutions for our clients.

As a group we are able to provide doors along with ironmongery solutions. This includes direct distribution as well as distribution to OEM suppliers such as manufacturers of modular buildings and retail stores. Our aim is to provide high quality, affordable door solutions supported by comprehensive certification and also assistance in project-specific approvals.

In addition to distribution and supply, we offer a one-stop solution or design, estimation, scheduling and manufacturing. Our supply and logistic services include shipping, customs clearance, de-bulking, storage (if required) and onward delivery to our client's premises or any desired location.

We support all doors requirements ranging from non-fire rated to fire rating up to FD 120, offering BS, ANSI and ISO standards as well as high performance acoustics and severe duty doors. We believe in delivering accurate and cost effective door solutions on time and in full.

### Focused on Sustainability

Our manufacturing facility and supply chain compliance adheres to strict ISO and FSC standards, which makes us not only a cost-effective and dependable supplier, but an environmentally conscious one as well. And to solidify ourselves in the market as the leading sustainable choice, we shall pledge two additional measures. Firstly, we compensate any carbon footprint created by shipping to our clients by purchasing equivalent carbon credits. And secondly, we have partnered with Trees for Life to plant trees in the UK to further contribute to our collective sustainable, healthy, and green future.

Trees for Life

Rewilding the Scottish Highlands  
Ath-fhiadhachadh na Gàidhealtachd



## Manufacturing Facility in India

Our state-of-the-art factory is located in Kandla, Gujarat in the North West of India. The two buildings were constructed in 2008 and have a combined floor area of 19,500 m<sup>2</sup>. The facility is equipped with high caliber machinery and well experienced staff, allowing us to manufacture products to the best international standards. The machinery list is extensive and includes jumbo Beam Saws, 3 Lipping machines, Calibration Sanders, 3 Single Presses, 3 CNC machines, a 3 -coat UV lacquer line along with a bespoke joinery shop and complete painting facility. It is an extensive factory, capable of delivering large projects efficiently and to the finest quality. New capital investments are continuously made towards machinery including recent upgrades made to our Frame manufacturing machines, Veneer Cutting and Stitching and Wrapping machine and new Paint booths. Furthermore, we maintain an abundant stock of select quality raw materials and tools. The facility also allows us to fully prepare doorsets for ironmongery and to fit non-protruding items, if required.

## Quality Assurance

The facility has a full suite of quality and environmental accreditations which are all 3rd party audited and verified. These include ISO9001 and full chain of custody.

## Flexible Production

The factory has a capacity of manufacturing 3000 doorsets per month that can be extended up to 4500 doorsets (in extended shifts) depending upon project requirements. Individual components such as Architrave or Vision Panel Cassettes are also manufactured in matching timeline. The product offer is extensive, and our manufacturing lead times are supported by a large stock holding of hardwood, door cores and veneers enabling us to move into manufacturing quickly from point of order.



# Certification

All our fire-rated products are tested to BS476 Part 22 and BS EN 1634-1 and certified through BM Trada under the Q-Mark scheme or manufacturing fire doors. We are amongst the very few companies in the world who are also able to offer a full range of American standard fire doors and frames to the (ANSI) UL10C standard. This offer is fully certified through Intertek and can include timber finished composite fire doors up to 90 mins with matching timber finished frame, or fully finished steel frames.

All general certification along with fire testing, acoustic testing and mechanical test evidence is available on request.

Bureau Veritas Certification



**TIMBMET DOOR SOLUTIONS (P) LTD.**  
 PLOT NO. 224-227, SECTOR - 4, KASEZ, GANDHIDHAM, KUTCH - 370 230, GUJARAT, INDIA.

*Bureau Veritas Certification Holding SAS - UK Branch certifies that the Management System of the above organization has been audited and found to be in accordance with the requirements of the Management System Standard detailed below.*

Standard  
**ISO 9001:2015**  
 Scope of certification

MANUFACTURE & EXPORT OF FIRE RATED TIMBER DOORS & DOOR SETS

Original cycle start date: 09 May 2013  
 Recertification cycle start date: 23 June 2022  
 Subject to the continued satisfactory operation of the organization's Management System, this certificate expires on: 03 July 2025  
 Certificate No.: IND.22.10913/QM/U Version: 1 Revision date: 23 June 2022

*J. Manian*  
 Signed on behalf of BVCH SAS UK Branch  
**Jogatheesh N. MANIAN**  
 Director - CERTIFICATION, South Asia  
 Commodities, Industry & Facilities Division

Certification body address: 5th Floor, 66 Prescot Street, London, E1 8HG, United Kingdom.  
 Local office: Bureau Veritas (India) Private Limited (Certification Business) 72 Business Park, Marol Industrial Area, MIDC Cross Road "C", Andheri (East), Mumbai - 400 093, India.

Further clarifications regarding the scope of this certificate and the applicability of the management system requirements may be obtained by consulting the organization. To check this certificate validity please call +91 22 6274 2000.



Bureau Veritas Certification



**TIMBMET DOOR SOLUTIONS PRIVATE LIMITED**  
 PLOT NO.224-227 SECTOR -IV KASEZ, 370230, GANDHIDHAM KUTCH, INDIA

*Bureau Veritas Certification Holding SAS certifies that the company has implemented a FSC™ product groups control system according to the Forest Stewardship Council™ certification system, in the following location and complies with the requirements of Standard FSC Chain of Custody Certification standard, Ref: FSC-STD-40-004 V 3.0*

For its activities concerning:  
**Manufacturing Of Doors & Doorsets And Trading In High Pressure Laminates Certified FSC Mix**

All sites included in the scope of this certificate are listed in annex. The covered products and processes/activities are performed by the network of Participating Sites, and not necessarily by each of them.

\*Updated list of products & species on the FSC database (info.fsc.org)

Type of certification : Single  
 Original certification date: 18 September 2008  
 Date of certification decision: 21 October 2019  
 Expiration date: 17 September 2023  
 FSC Certificate code: BV-COC-018546  
 BV Certificate No. / Version: IND31972 / V1  
 Contract No.: 4377291  
 Issue date: 23 October 2019

*Key*  
 Signed off on behalf of Bureau Veritas Certification Holding

The validity of this certification shall be verified on: info.fsc.org.  
 This certificate itself does not constitute evidence that a particular product supplied by the certificate holder is FSC-certified or FSC Controlled Wood. Products offered, shipped or sold by the certificate holder can only be considered covered by the scope of this certificate when the FSC Chain of Custody is clearly traced on sales and delivery documents.  
 Accredited office: Bureau Veritas Certification Holding - B, cours du Triangle - 92800 Puteaux - France: www.bureauveritas.com

Certification decision office: Bureau Veritas Certification China, F22, Tower B, Beijing Global, Third Ring Road East, Dongcheng District, Beijing 100013, China  
 Contracting office: Bureau Veritas Certification India  
 A list of the products or services that are included in the scope of the certificate may be obtained on request to Bureau Veritas Certification. All copies or reproductions of this certificate remain the property of Bureau Veritas Certification, all copies or reproductions and the certificate itself shall be destroyed on Bureau Veritas certification request. All certificates not in English are for reference only.



The mark of responsible forestry

Bureau Veritas Certification



**ANNEX n° I/I**

PARTICIPATING SITE	ADDRESS	SCOPE: Activity + Product + FSC Category	Sub-code	Date of integration in the scope
Timbmet Door Solutions Private Limited	Shed No 345 and 346A, Sector IV Kandla Special Economic Zone (KASEZ), Taluka Gandhidham, Kutch-370230, Gujarat, India	Manufacturing of Doors & doorsets	A	21 October 2019

# MAYFAIR

FIRE SOLUTIONS







# RECENTLY COMPLETED PROJECTS



## NBK Children Hospital, Kuwait

Contractor: Wood Expressions LLC

Consultant:

Value: GBP 1,100,000.00



## Qatar National Museum Qatar

Contractor: Hyundai Engineering

Client: Astad

Consultant: Jean Nouvel,

Value: GBP 1,500,000.00



## Msheireb Downtown Doha Qatar

Contractor: Carillion QBCJV

Client: Msheireb Properties,

Consultant: Time Qatar

Value: GBP 1,650,000.00



# RECENTLY COMPLETED PROJECTS



## Oberoi Realty Limited

Contractor:  
Consultant:  
Value: GBP 1,800,000.00



## Middlewood Locks

Contractor:  
Consultant:  
Value: GBP 2,060,000.00



## Omkar Realtors and Developers Pvt. Limited

Contractor:  
Consultant:  
Value: GBP 7,000,000.00



# OTHER PROJECTS



## Perth Childrens Hospital

Client: John Holland  
Value: GBP 1,428,896.97



## Alzeina

Client: ALDAR Laing O'Rourke Construction  
LLC Value: AED 2,264,1208.00



# OTHER PROJECTS



## Perth Childrens Hospital

Client: John Holland  
Value: GBP 1,428,896.97



## Alzeina

Client: ALDAR Laing O'Rourke Construction  
LLC Value: AED 2,264,1208.00



# OTHER PROJECTS

Project	Customer	Type	Year	Door / Sets Qty
Sobha Hartland Green Phase 3 LLC	Mughal Wood Works	Doorset	2020	1544
Al Methaq Bldg Cont LLC	Mughal Wood Works	Doorset	2020	2534
Al Qabdah Building Contracting LLC	Doorsets International - UK	Doorset	2019	1627
University of Kent - UK	Doorsets International - UK	Doorset	2018	538
East Street Student Accommodation - UK	Doorsets International - UK	Doorset	2018	1006
Royal Wharf - UK	Doorsets International - UK	Doorset	2017	723
Oberoi Esquire - India	Oberoi Realty Ltd	Doors	2017	8800
Middle Wood Locks - UK	ERA Realtors PVT. LTD.	Doors	2017	2863
Alta Monte Omkar - India	Leaderflush Shapland	Doors	2016	2570
Qatar National Museum - Qatar	Wood Expressions LLC	Doorset	2016	2500
Heart Of Doha - Qatar	Wood Expressions LLC	Doorset	2015	3315
NBK Children Hospital - Kuwait	Wood Expressions LLC	Doorset	2015	290
Elephant Road - UK	Leaderflush Shapland	Doors	2014	2175
New Children Hospital - Perth	Aldar / Laing O'Rourke	Doors	2013	3625
Crown Place - UK	Nestle India Limited	Doors	2012	4008
Al Raha Beach Development - Dubai	Carillion Construction Limited	Doorset	2011	24500
Food Factory - India	TDSL	Doorset	2011	350
Al Muneera - Abu Dhabi	Bouygues Batiment	Doorset	2011	1200
Southern General Hospital - UK	Doorsets International - UK	Doorset	2010	855
IGP Govt. Office - Turkmenistan	Doorsets International - UK	Doorset	2010	1125



# MANUFACTURING PROCESS



**MAYFAIR**  
FIRE SOLUTIONS



# BESPOKE DOORS

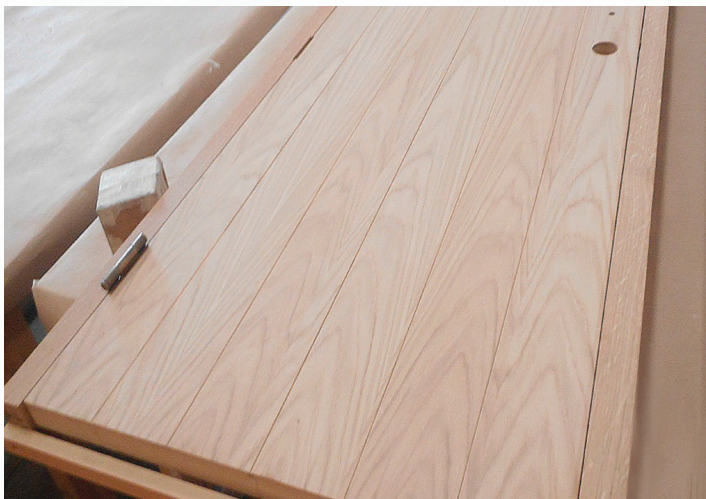

**MAYFAIR**  
FIRE SOLUTIONS



# DOOR LEAF CONSTRUCTIONS

## British Standards

Our doors combine solid constructions, high quality raw materials and detailed manufacturing management in order to produce cost -competitive performance doorsets.

In accordance with British Standards, our door leaf construction is based on a graduated density chipboard core with a minimum thickness of 38mm. Hardwood lipping which are fitted to all four edges or two long edges of the door, are a minimum of 6mm in hardwood and can be concealed or exposed to match the decorative facing on the leaf. The door leaf face will meet the customer's requirement and will generally be finished in laminate, prime coat only, full factory paint, or veneer. The sub -face and thickness of the door will depend on its performance requirement. All doors are durability tested to DD171, have a severe duty rating and are fire rated from FD30 through to FD120. Acoustics range from 32 dBRw to 38 dBRw within our standard offer (see table below). However, enhanced acoustics are available on request.



# DOOR LEAF CONSTRUCTIONS

## Performance Summary - British Standards

Fire Rating		Single Leaf (mm)		Double Leaf (mm)		Finished Leaf Thickness (mm)
		Height	Width	Height	Width	
FD30	From	2135	1200	2135	1100	44
	To	2800	915	2600	910	
Acoustic performance (dBRw)	Unglazed		33		32	
	Glazed		35		35	
FD60	From	2441	1384	2300	1142	54
	To	3050	825	2850	825	
Acoustic performance (dBRw)	Unglazed	34		33		
	Glazed	35		35	0	0
FD90	From	2400	1072	2150	940	64
	To	2450	1047	2200	915	
Acoustic performance (dBRw)	Unglazed	34		33		
	Glazed	35		35		
FD120	From	2395	1022	2395	997	60
	To	2660	915	2610	915	
Acoustic performance (dBRw)	Unglazed	38		37		
	Glazed					



# DOOR LEAF CONSTRUCTIONS

## ANSI Standards

To meet American ANSI/NFPA/UL standards, we use a 38mm thick mineral core as the base material. Sub faces are applied depending on the performance requirement of the door and then are factory finished. The same mineral material is used for door frames which is then given its factory surface finish (usually veneer). We can also offer a steel frame solution. The American standard fire test has an additional hose stream element as part of its requirement, which is the reason for the use of composite mineral materials in the core.

The core will be supplied with a high -density stile and rail, if required, along with hardwood lipping which conceal the intumescent seals. Fire ratings extend to 90 minutes with acoustics rated to 40 STC. All hardware requirements can be prepared for in the factory.



# DOOR LEAF CONSTRUCTIONS

## Performance Summary - ANSI Standards

Fire Rating	Single Leaf (mm)		Double Leaf (mm)		Finished Leaf Thickness (mm)	
	Height	Width	Height	Width		
FD30	From	2135	1200	2135	1100	44
	To	2800	915	2600	910	
Acoustic performance (dBRw)	Unglazed		33		32	
	Glazed		35		35	
FD60	From	2441	1384	2300	1142	54
	To	3050	825	2850	825	
Acoustic performance (dBRw)	Unglazed	34		33		
	Glazed	35		35	0	0
FD90	From	2400	1072	2150	940	64
	To	2450	1047	2200	915	
Acoustic performance (dBRw)	Unglazed	34		33		
	Glazed	35		35		
FD120	From	2395	1022	2395	997	60
	To	2660	915	2610	915	
Acoustic performance (dBRw)	Unglazed	38		37		
	Glazed					



# DOOR LEAF LIPPING DETAILS

Lipping is applied to all four edges to provide optimum protection. Both exposed and concealed lipping is available with all of our doorsets. We use certified hardwood from a range of timber species to match or contrast the door veneer or laminate. Lipping can be square edged or have a pencil roundness to soften the edge if required. Should you require the door to comply with Equality Act requirements, we can add a contrasting colour insert within the lipping.

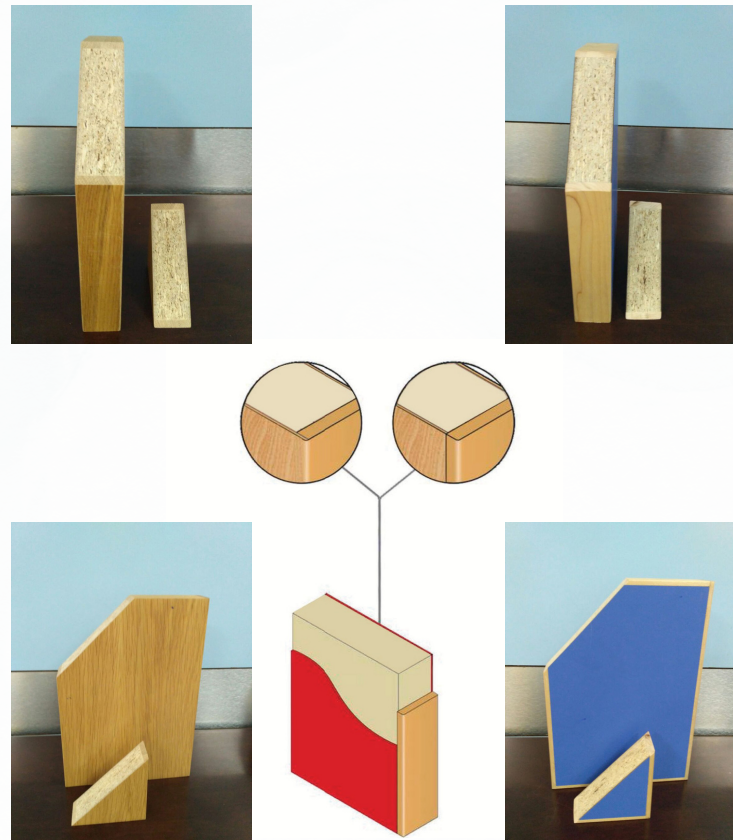



# DOOR LEAF FINISHING OPTIONS

All Door Leaf finishes are available to suit all Fire and Acoustic ratings listed.

## Kraft Paper Primed

This finish uses a lipped GDC core with a 0.4mm Kraft paper layer bonded to its surface. The application is applied 'over lip' to eliminate cracking. Glazing beads are factory primed to match. This finish offers a durable low-cost door leaf which can be decorated on site.

## Factory Double Primed

Generally used on a minimum door thickness of 44mm, TDSL offers a superior and durable undercoat finish to the doorsets where a finishing coat is to be applied on site. Using a 38mm core, 3mm MDF sub -faces are applied over the hardwood lipping. The whole leaf including the glazing bead is then double primed for a single top coat to be applied on site.

## Full Paint

Our fully factory painted offer follows the same make up as the double primed product. However, we apply the finished top coat in the factory in line as per project specification. This option offers a far superior finish to site painting and speeds up installation and handover of the doorset on site. Care must be taken not to damage the surface finish whilst in storage or during installation. We offer a vast range of RAL/BS colour options and various gloss levels to suit each individual client's specification.



## Veneers

Veneers, along with all our timber products are sourced ethically. We offer a wide range of veneers including some exotic species and these, in turn, can be cut to suit the project requirements (for example, crown or quarter cut). Our standard veneer thickness is 0.6mm. Lipping and glazing beads generally match the door face veneer and are veneered over lip as standard unless otherwise instructed. The door leaf is finished in a 3 coat UV lacquer line which provides a constant high class and durable final finish.

Exotic veneers are available on request.

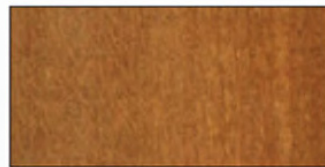

Sapele Veneer

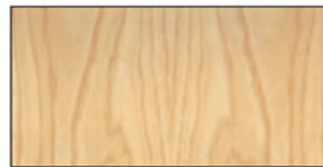

Ash Veneer



Steamed Beech  
Veneer



Koto  
Veneer

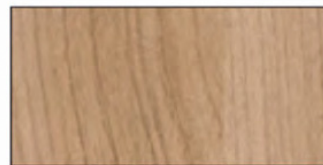

Cherry Veneer



Maple  
Veneer

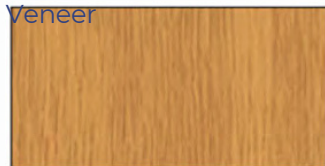

White Oak  
Veneer

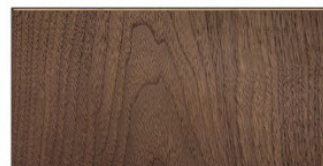

Black Walnut  
Veneer



**Crown Cut** - The log is sliced along its length, resulting in a figured appearance. This generally produces a veneer with a central area of strong figurative grain.

**Quarter Cut** - The log is cut along its length to form four separate quarter logs. These are then sliced at 90 degrees to the growth rings to provide a veneer with a relatively uniform linear vertical grain.

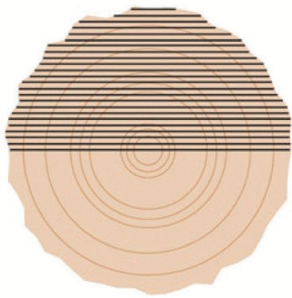

Crown cut

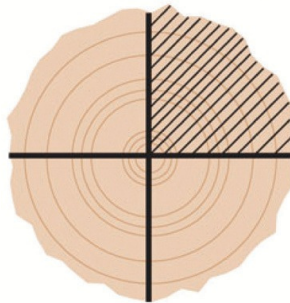

Quarter Cut





## Laminate and PVC faced

Our (HPL) laminate faced doors are hard -wearing, stain -resistant and can be supplied up to FD120 fire rating. These doors are generally used in high traffic areas. We supply from a vast range of plain or woodgrain laminate suppliers all of whom are accredited in line with our own products. Laminate thicknesses can vary to suit the project but will be a minimum of 1.2mm in thickness. Lipping can be exposed or can be supplied with the laminate over the lipping, including partial lipping where we chamfer back the edge of the laminate to protect its leading edge from damage during its life cycle. For wet areas and areas where there is likely to be heavy impact to the door, we can offer PVC faced doors. The facing would generally be 2mm thick with a matching finished lip detail. The maximum fire rating for the PVC door offer is FD90

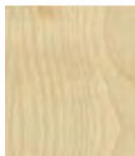

K7555  
Matte 58  
Manitoba  
Mapel

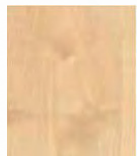

F3855  
Matte 58 Clear  
Mapel



K7024  
Matte 58  
Birch

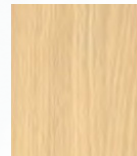

F2726  
Matte 58  
Natural  
Beech



K7603  
Matte 58  
Bio -Oak



K7604  
Matte 58  
Blond Oak



K7016  
Matte 58  
Fin Beech



K6149  
Matte 58  
Light Oak



K7021  
Matte 58  
Vivid Cherry



F1293  
Matte 58  
Redwood



K7759  
Matte 58 Select  
Cherry





## Vision Panels

All glazed doors are generally factory glazed to ensure the certification and specified performance of our doorsets are met incorporating the correct glass for the fire requirement and vision panel type. The vision panel bead design is generally a bolection type bead in fire applications although flush beads can be provided (as shown). DocM indicates vision panels that comply with the UK Document M standard requiring a zone of visibility between 500mm and 1500mm from the floor. The visibility Exotic veneers are available on request

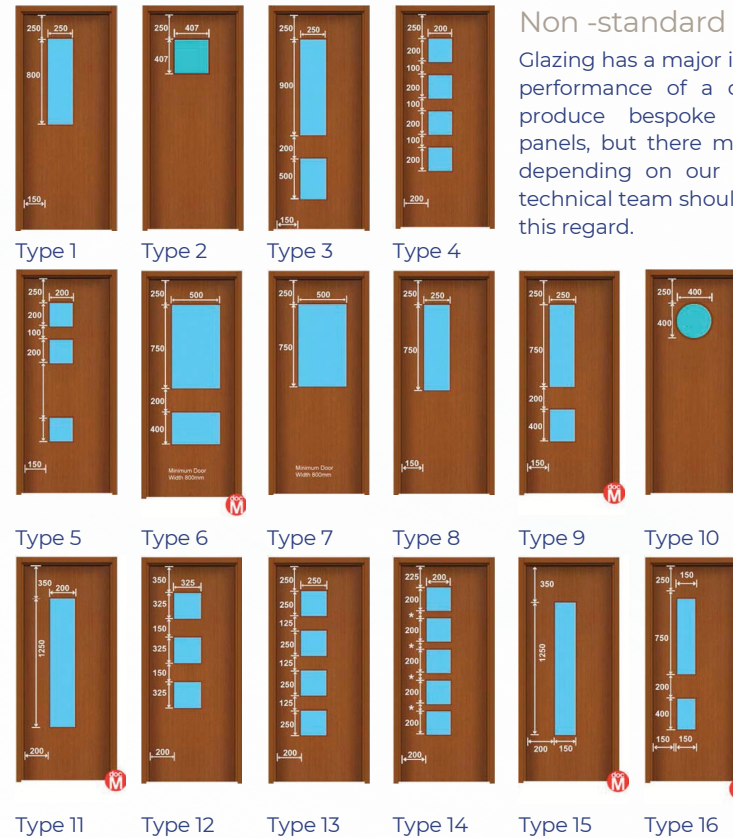

### Non -standard vision panels

Glazing has a major impact on the fire performance of a doorset. We can produce bespoke sizes of vision panels, but there may be limitations depending on our certification. Our technical team should be consulted in this regard.



## Standard Glazing Beads

Our standard vision panels can be fire rated in association with the standard bead details shown below. These include a hardware bolection bead, flush bead and steel trim option. All provide FD60 rating. Hardwood beads can be finished to match the door facing and are generally pin fixed, punched and filled. Screw fixing can be accommodated as well. Steel trims can be painted to a standard BS / RAL colour.

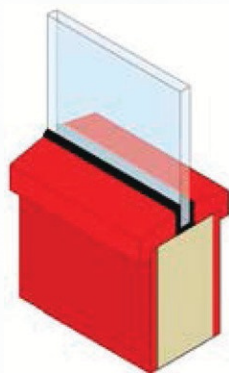

Hardware 'Bolection' Bead

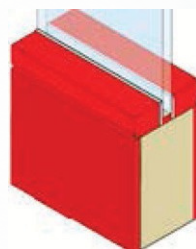

Flush or 'Quirk' Bead

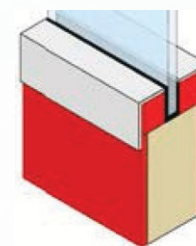

Steel Trim Bead



## Frame Options

Frames can be supplied in a variety of materials including, moisture resistant MDF in either primed or painted finish, softwood in primed, painted or lacquered finish, hardwood in primed painted or lacquered finish or engineered MDF frames with hardwood edges and a veneer or PVC facing.

**Fixed rebate frame:** A sturdy single piece frame with either Fixed rebate single or double rebate. Once fixed on site, the frame will need frame to be pelleted and repaired to conceal the fixings to match the final finish. This frame can be offered with an extension lining for wide partitions.

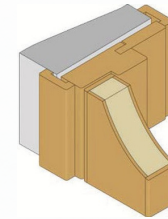

Fixed rebate frame

**Loose stop frame:** A 2-part frame consisting of a flat main frame supplied with a loose stop to be fixed on site. The frame fixings can be concealed under the stop. Once pinned in the stop, it can be simply waxed to hide the pins. This frame can Loose stop be offered with an extension lining for wide partitions.frame

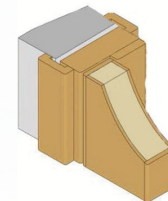

Loose stop frame

**Wrap around frame:** A 3 -part frame consisting of a 2 -part wrap around frame and a stop. This frame does not use architraves and can be used to achieve a shadow gap effect. The stop will hide the frame fixing points and is waxed after pinning.

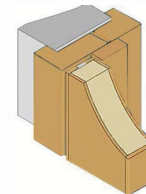

Wrap around frame



## Engineered Frame

**MDF veneered frame:** This is a moisture -resistant MDF frame with hardwood edges for durability and a veneer lacquered outer face with a loose hardwood stop. These frames look and perform like solid hardwood frames but offer a lower cost solution.

**PVC Frames:** Moisture -resistant MDF or hardwood frames depending on the fire rating wrapped in 2mm PVC. These frames come with PVC covered architraves and stops and can be in loose stop or wrap around configuration.

**Steel frames:** Traditionally used in security and industrial situations, but suitable for all applications. Available in a range of sizes. Can be supplied as a single rebated frame or split adjustable wrap around variant with integrated architrave. This product is available to cater for varying partition thicknesses and improved finishing aesthetics.

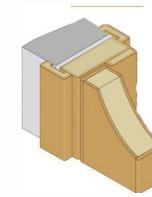

MDF veneered frame

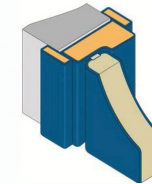

PVC Frames

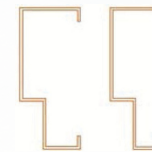

Steel frames



## Perimeter Seals

Designed to fit into a recess in the frame, the perimeter seal provides protection against cold smoke ingress and its correct specifications. Installation is critical in providing the enhanced acoustic properties of the doorsets.

- Located in head and jambs of single and double doors
- Friction fit into 3mm recess
- Min/Max gap size 3 - 4mm
- Dual air pocket technology to increase acoustic performance
- BS 476 Pt31 and BS EN 1634 -3 and UL 10C smoke seal compliant
- Service life tested to 1 million cycles
- Ultra -soft blades to minimize opening/closing forces to optimize compliance with Approved Document M of The Building Regulations
- Stock colours: Black, Brown, White, Grey
- Seals are supplied loose for site fixing

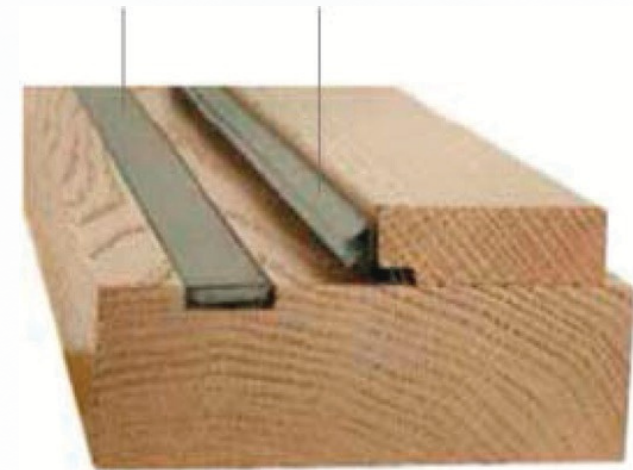

Intumescent seal with twin blade perimeter seal



## Architraves

Architraves can be supplied in either softwood primed or MDF paper wrapped.

\*for site painting or factory finished hardwood to match the frame.

\*Only available in sizes 45x15mm and 69x15mm.

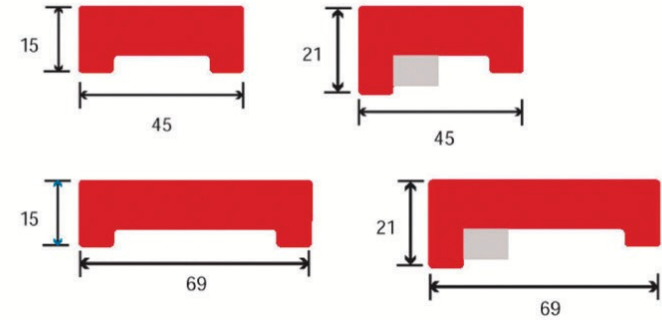



## Factory Installed Ironmongery for Doorsets

We provide a fully coordinated suite of Ironmongery products including items that are factory fitted and are an integral part of the performance of the doorset. Separate surface fixed ironmongery can be supplied door bagged or in bulk to provide a fully integrated door set and Ironmongery package. Numerous designs and finishes are available from classic to contemporary to innovative, with matching ancillary products to accommodate all architectural trends and performance requirements.



Factory fitted glazing with hardwood glazing beads. Available in a choice of glazing types.



Factory preparation and fitting of flush bolts top and bottom on equal and unequal pairs of doors.



Recessed and fitted fixed pin and lift off hinges.



Mortice lockcases are factory prepared and fitted providing high quality finish and reduced on-site installation.



Factory preparation and fitting of intumescent and acoustic seals with Integrated smoke seals

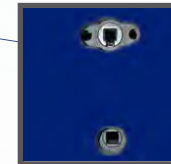

Factory preparation of door faces for the fitting of lever and cylinder hardware (except single cylinders).



Acoustic drop seals are factory fitted to the base of the door where specified

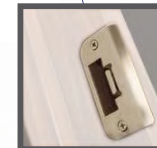

Factory preparation and fitting of adjustable lock strike for standard bathroom lock, latch, deadlock and sashlock. Speeds up installation and allows perfect alignment of latch and deadbolt.



## Market Sectors

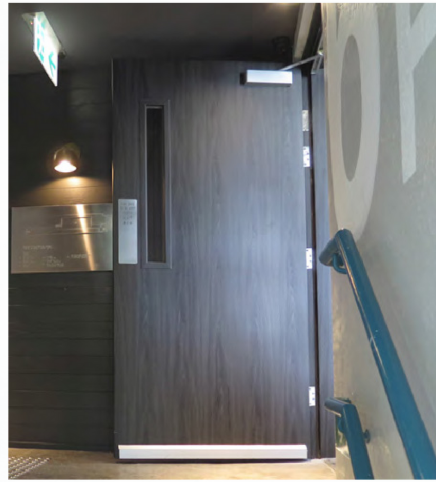

As experienced manufacturers of high-performance doors, we are fully equipped to offer specific solutions for Health, Education, Commercial, Residential and Leisure projects. We have the capability to specify, quote, schedule, manufacture and certify doorsets and hardware package solutions that are fully compliant and fit for purpose.



With a wide range of door finishes and colours available, our offered doorsets meet the performance, safety and compliance guidelines for project and market sectors. Innovative colour schemes can be delivered including leaf graphics offering contemporary designs to the specifier and end user. We take a collaborative approach to working with our clients to ensure design and performance requirements of the project are met whilst still complying with the relevant local area building regulations and certification requirements

**MAYFAIR**  
FIRE SOLUTIONS



# DELIVERY LOGISTICS

## Our door to door service promise

Buying products from us is easy. Place an order with us including all the relevant manufacturing details you require and within 4-10 weeks, the product will arrive at your specified delivery address. There is no need to worry about arranging shipping, customs clearance, duties, documents and transportation, for we will arrange it all and this service it is included in the quoted price.

Our standard lead time from order to supply to our India customers is 5 weeks and 6 weeks to Middle East. Delivery to Gulf region will be 6 weeks and one weeks for clearance. For UK customers, our average lead time is 9 weeks.

The product is shipped in either 20' or 40' high cube shipping containers. The internal dimensions of a 40' container are:

Length 12.051 m (39' 6 Y>")

Width 2.340m (7' 8"

Height 2.380m (7' 9Y>")

A loading dock or container ramp is required for unloading.

Typically, a full 40' container will hold 400 door leaves packed on 20 pallets with 20 leaves per pallet. All doors are individually packed in a plastic sleeve, labelled, then banded to the pallet with top and edge protection. If doors are glazed, the packing specification reduces to 16 leaves per pallet with 5mm bearers between leaves to protect the glazing beads. For full doorsets, 280 sets will fit into a 40' container, including 14 pallets of 20 leaves with 6 pallets of frames. The frames can be supplied as numbered knocked down frames wrapped as a complete set with all stops and architraves (or as frame jambs and head together) or stops and architrave on separate pallets. When ironmongery is ordered we prefer to fit all morticed components in the factory to the leaves and frames. Surface mounted items will be supplied in bulk on a separate pallet.





### FACTORY

Kandla Special Economic Zone  
Gandhidham, Dist. Kutch,  
Gujarat, India

### INTERNATIONAL SALES OFFICE

Bay Square, Business Bay,  
Dubai, UAE

Middleton, Greater Manchester,  
United Kingdom

### CONTACT

[sales@mayfairfiresolutions.com](mailto:sales@mayfairfiresolutions.com)



The mark of  
responsible forestry



**MAYFAIR**  
FIRE SOLUTIONS